

2520190030572

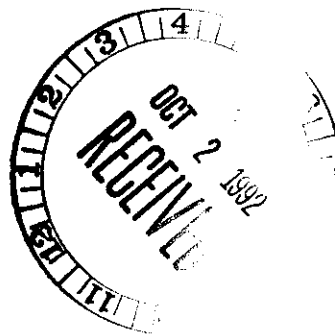

05080

JOHNSTON CONSTRUCTION COMPANY
 4331 FOX RUN ROAD, P.O. BOX 98
 WYOMING, PA 17315

VENDOR NO.

VENDOR NAME

TRANSACTION DATE	REFERENCE	GROSS AMOUNT	DEDUCTION	NET AMOUNT
09/24/92		\$1,000.00	\$0.00	\$1,000.00
CHECK DATE	CHECK NO.	TOTAL GROSS	TOTAL DEDUCTIONS	CHECK AMOUNT
09/24/92	33334	\$1,000.00	\$0.00	\$1,000.00

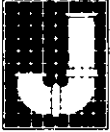

JOHNSTON
CONSTRUCTION
COMPANY
P.O. Box 98
Dover, Pa. 17315-0098 Ph. 717-292-3606

MULTI-TRADE
ENGINEERED
CONSTRUCTION

September 25, 1992

PENSION AND WELFARE BENEFITS ADMINISTRATION
P.O. Box 75212
Washington, D.C. 20013-5212

Re: Notice of Plans of Deferred Compensation

Gentlemen:

Pursuant to DOL Reg. Sec. 2520.104-23, the undersigned Employer hereby files the following information with respect to its plans of deferred compensation.

1. Johnston Construction Company
P.O.Box 98
Dover, PA 17315
2. Federal Employer Identification No. (EIN):
23-2216549
3. The Employer maintains three (3) plans of deferred compensation primarily for the purpose of providing deferred compensation to a select group of management or highly-compensated employees.
4. Three (3) employees are covered by such plans.

05080

Very truly yours,

JOHNSTON CONSTRUCTION COMPANY

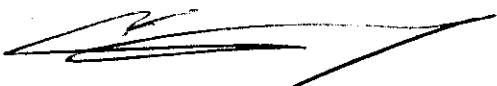
Charles L. Zitnick, Jr., P.E.
Chief Executive Officer

CLZ/lit

ENCLOSURE: CHECK FOR \$1,000.00
CERTIFIED NO. P 737 207 621

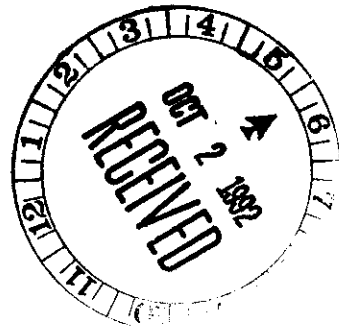

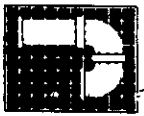

**JOHNSTON
CONSTRUCTION
COMPANY**
P.O. Box 98
Dover, Pa. 17315-0098 Ph. 717-292-

717-292-2929

fold at this line over top of envelope to the
right of the return address.

CERTIFIED

P 737 207 621

MAIL

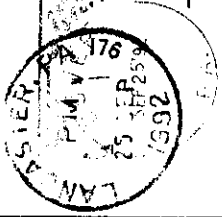

POSTER
3046915

U.S. POSTAGE

